

Wendeplatten-Falzmesserkopf in Leichtmetall

Cutter block with tungsten carbide turnover-knives
 Porte-outils à feuillure et à dresser à plaquettes réversibles au carbure
 Placas reversibles para portachillas ranuradoras en metal ligero



Abmessung Dimension Medidas D Ø x B x d Ø mm	Messer Knife Fers Cuchillo	Vorschneider Spurs Araseur Placa reversible de macho inicial	Best.-Nr. Order-No. Ref.-No. Réf.-No.	EUR*
100 x 30 x 30	2	4	1 004 030	116,40
100 x 40 x 30	2	4	1 004 040	118,70
100 x 50 x 30	2	4	1 004 050	122,20
125 x 30 x 30	2	4	1 254 030	125,10
125 x 40 x 30	2	4	1 254 040	130,30
125 x 50 x 30	2	4	1 254 050	136,10
125 x 60 x 30	2	4	1 254 060	165,50



mit ziehendem Schnitt
 with pulling cut
 avec la coupe de traction
 con corte de tracción

125 x 50 x 30	4	4	1 254 450	194,25
---------------	---	---	-----------	--------

Ersatzteile Spare parts pièces de rechange Piezas de recambio	Abmessung Dimension Medidas mm	Stück/Packung Number/pack Pièce/paquet Piezas/paquete	Best.-Nr. Order-No. Réf.-No. Ref.no.	EUR*
HW-Wendeplatten	30x12x1,5	10	0 305 510	2,70
	40x12x1,5	10	0 405 510	3,25
	50x12x1,5	10	0 505 510	3,50
	60x12x1,5	10	0 605 510	4,40
HW-Vorschneider	14x14x2,0	10	0 145 510	1,85
Schlüssel	S4		4 001	1,60
Senk-Passschraube			4 020	1,60

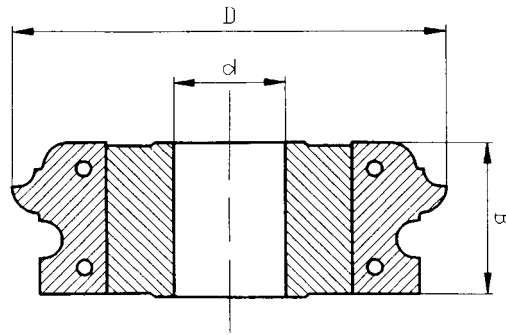
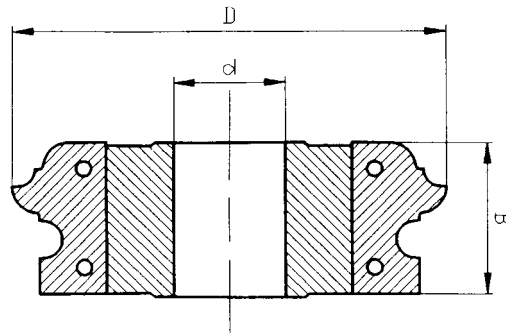
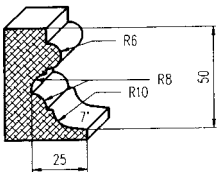
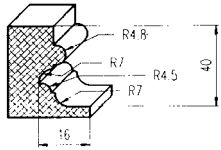
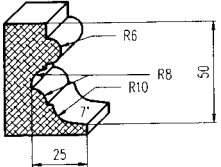
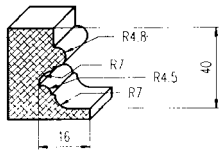

Best.-Nr. Order-No. Réf.-No. Ref.no.	EUR*
1 205 050	214,10
1 605 052	260,50
1 205 051	41,70
1 605 053	47,30

Hartmetall-Wendeplatten-Verleimfräser

Glue-joint cutter block
Fraise pour joints collés
Fresa de encolar WPL

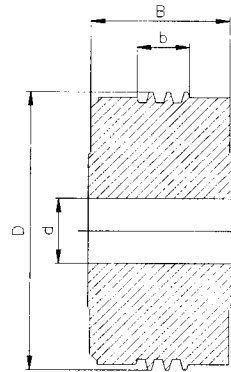
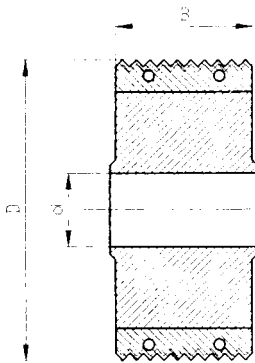

Abmessung Dimension Medidas Ø mm	B	d	Z	Best.-Nr. Order-No. Réf. No. Ref.no.	EUR*
120	50	30	2	1 205 600	185,20
130	50	30	2	1 305 602	317,80
130	60	30	2	1 306 604	332,90
HW-Wendeplatte 50x12x1,5 mm				1 205 601	27,20
HW-Wendeplatte 50x24x2,0 mm				1 305 603	53,20
HW-Wendeplatte 60x24x2,0 mm				1 306 605	56,70

Hartmetall-WPL Schwenkmesserkopf

TCT adjustable chamfering cutter
 Porte-outil à têtes inclinables à plaquettes carbure réversibles
 Portachuchillas regulable WPL

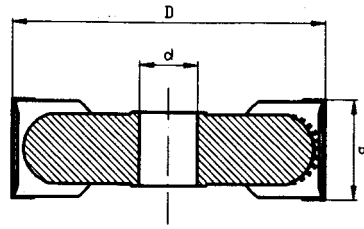
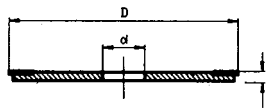

Abmessung Dimension Medidas	Ø mm		Zähnezahl No. teeth Denture Dentado	Verstellwinkel Adjusting angle Angle de réglage Angular posteriore	Best.-Nr. Order-No. Réf.-No. Ref.no.	EUR*	
	B	d					
	110	40	30	2	0-45° stufenlos	1 105 700	384,90
	160	50	30	2	0-90° stufenlos	1 605 702	465,30

HW-Vorschneiderplatte

160	30	V2	1 605 705	142,40
HM-Wendeplatten	40x12x1,5 mm		0 405 510	3,25
HM-Wendeplatten	50x12x1,5 mm		0 505 510	3,50
HM-Vorschneider	14x14x2,0 mm		0 145 510	1,85

Hartmetall-Wechselplatten Konterprofil Fräskopf

TCT counter profile cutter block
 Porte-outil à contre-profil au carbure
 Placas reversibles de metal duro para fresas de contraperfilado

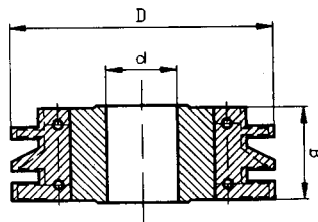
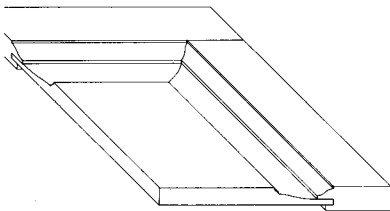

Abmessung Dimension Medidas	Ø mm		Zähnezahl No. teeth Denture Dentado	Best.-Nr. Order-No. Réf.-No. Ref.no.	EUR*
	B	d			
120	40	30	2	1 205 800	241,90
HM-Wechselplatte		40x26x2 mm	Profil 1 - R4	1 205 802	44,60
HM-Wechselplatte		40x26x2 mm	Profil 2 - R5	1 205 804	44,60
HM-Wechselplatte		40x26x2 mm	Profil 3 - R6	1 205 805	44,60
HM-Wechselplatte		40x26x2 mm	Profil 4 - 26,5°	1 205 806	44,60

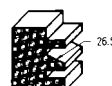
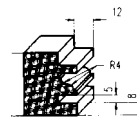

Zweiteilig, durch Zwischenringe verstellbar. Zum Nuten von Holz- und Holzwerkstoffen. Einwandfreie Schnittergebnisse durch Vorschneiderausführung.

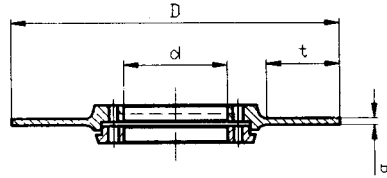
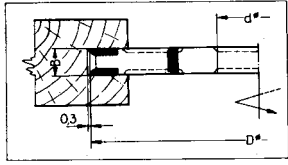

Abmessung Dimension Medidas			Zähnezahl No. teeth Denture Dentado	Nuttiefe max. Grooving depth Profondeur à rainurer Profundidad de freado	Best.-Nr. Order-No. Réf.-No. Ref.no.	EUR*
Ø D mm	B	d				
130	4 - 7,5	30	4 + 4	20	1 305 100	355,40
180	4 - 7,5	30	8 + 4	35	1 805 105	367,00
180	8 - 15	30	4 + 4	35	1 805 106	373,40

Hartmetall-Wendeplatten – Verstellnutter mit Gewindebüchsen

Tungsten panel raising cutterblock – Adjustable grooving cutter on threaded bush
Fraise à plate-bande au carbure – Porte-outil à rainur extensible par manchon fileté
Fresas ranuradoras regulables con casquillo enroscable

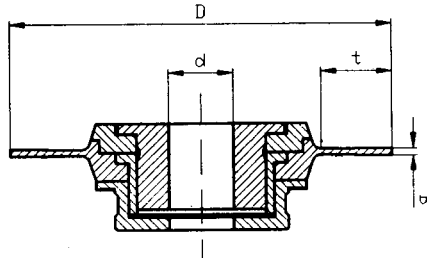
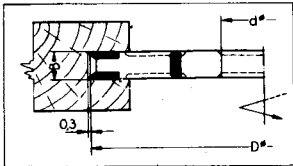



Abmessung mm Dimension Medidas			Zähnezahl No. teeth Denture Dentado	Nuttiefe max. Grooving depth Profondeur à rainurer Profundidad de freado	Best.-Nr. Order-No. Réf.-No. Ref.no.	EUR*
Ø D mm	B	d				
130	4 - 7,5	30	4 + 4	20	1 305 110	530,20
180	4 - 7,5	30	8 + 4	35	1 805 115	554,60
180	8 - 15	30	4 + 4	35	1 805 116	492,00

Ersatzteile Spare parts Pièces de rechange Piezas de recambio	Abmessung Dimension Medidas mm	Stück/Packung Number pack Pièces par paquet Piezas por paquete	Best.-Nr. Order-No. Réf.-No. Ref.no.	EUR*
HW-Räumerzähne	18 x 18 x 1,95 (für 4-7,5 mm)	10	1 818 195	8,60
HW-Wendeplatten	7,5x 12 x 1,5 (für 8-15 mm)	10	0 075 510	1,70
HW-Wendeplatten	14 x 14 x 1,2 (für 4-7,5 mm)	10	0 146 510	3,30
HW-Wendeplatten	14 x 14 x 2,0 (für 8-15 mm)	10	0 145 510	1,80

Hartmetall-WendePlatten-Abplattfräser

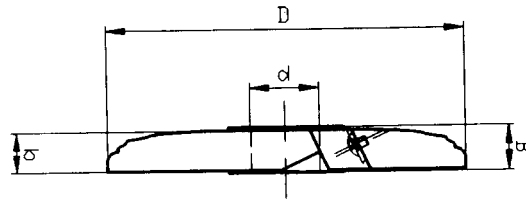
Tungsten panel raising cutter block
 Fraise à plate-bande au carbure
 Fresas de achatar de metal duro WPL

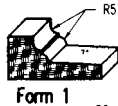

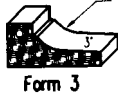

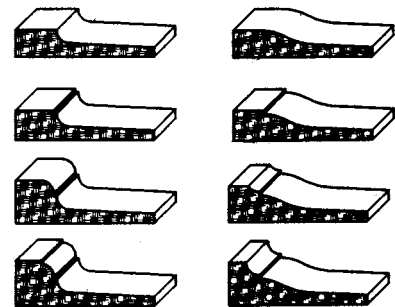
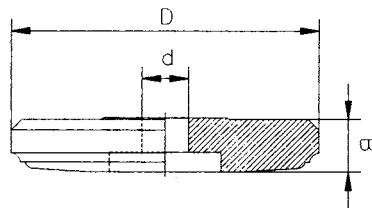

Abmessung Dimension Medidas				Best.-Nr. Order-No. Réf.-No. Ref.no.	EUR*
Ø D mm	B	d	Z		
160	20	30	2	1 605 040	195,10
					
					
					

Hartmetall-WendePlatten-Abplattfräser, 2-teilig

Tungsten panel raising cutterblock, split pattern
 Fraise à plate-bande au carbure, en deux pièces
 Fresas de achatar de metal duro WPL



Abmessung Dimension Medidas				Best.-Nr. Order-No. Réf.-No. Réf. no.	EUR*
Ø D mm	B	d	Z		
200	35	30	2 + 2 gerade, mit Profil 2 + 3	2005 036	324,10
200	35	30	2 + 2 profiliert, mit Profil 1 + 4	2005 038	324,10
					
					
					
					

* Unverb. Preisempfehlung zzgl. ges. MwSt.